



AIR CURTAIN SERVICE MANUAL



(GC201205-I)

CONTENTS

| | |
|--|----|
| PRODUCT | 2 |
| 1 Model List | 2 |
| 2 Nomenclature | 2 |
| 3 Functions | 2 |
| 4 Product Data | 2 |
| 5 Piping Diagram | 3 |
| CONTROL | 5 |
| 1 Wireless Remote Controller | 5 |
| 2 Wired Remote Controller | 5 |
| INSTALLATION | 7 |
| 1 Dimensions Data | 7 |
| 2 Clearance Data | 7 |
| 3 Installation Notes | 8 |
| 4 Installation Steps | 8 |
| MAINTENANCE | 10 |
| 1 Error Display | 10 |
| 2 Care And Maintenance | 10 |
| 3 Wiring Diagram | 10 |
| 4 Disassembly And Assembly Procedure Of Main Parts | 11 |
| 5 Exploded View And Spare Part List | 13 |
| 5.2 Parts List | 14 |

PRODUCT



PRODUCT

1 Model List

| Model | Product code | Air flow volume (m ³ /h) | Dimensions (W×D×H) mm×mm×mm | Appearance |
|--------------|--------------|-------------------------------------|-----------------------------|---|
| FM-1.25-9-K | CM5500040 | 1200 | 900×206×215 |  |
| FM-1.25-12-K | CM5500050 | 1650 | 1200×206×215 | |

2 Nomenclature

The model description of the air curtain comprises of capital letters and Arabic numbers. See the below table for more details:

| | | | | | | |
|----|---|-----|---|---|---|---|
| FM | - | 1.5 | - | 9 | - | C |
| 1 | | 2 | | 3 | | 4 |

| No. | Part name | Options |
|-----|----------------------------------|--|
| 1 | Unit code | FM-Air curtain without Heating, RM- Air curtain with Heating |
| 2 | Outer Diameter of the Impeller | Diameter=Value×100mm |
| 3 | Nominal width of the outlet flow | Width=Value×100mm |
| 4 | Added code | C-Vertical Installation, S-Heating by Warm Water, D-Electric Heating , other design codes etc. |

3 Functions

- Optimized design cross-flow and good performance motor are adopted
- Microprocessor control
- Reliable performance and long duration
- Both manual control and remote control available
- Anti-corrosion two-side painted electro-galvanized metal case
- Good strength structure provides airflow.

4 Product Data

| Model | Length | Diameter of wind wheel | Power supply | Power Input | Noise (high-speed) | Weight | Outline dimensions (W×H×D) |
|--------------|--------|------------------------|-----------------------------------|-------------|--------------------|--------|----------------------------|
| | mm | mm | - | W | dB(A) | kg | mm |
| FM-1.25-9-K | 900 | 125 | 220-230V~ 50Hz/ 220-230V~ 60Hz | 110W | 59 | 16 | 900×206×215 |
| FM-1.25-12-K | 1200 | 125 | 220-230V~ 50Hz/ 220-230V~ 60Hz | 140W | 61 | 20 | 1200×206×215 |

5 Piping Diagram

The air curtain can inhale the air inside the room through the cross flow fan, and then blow it out in continuous, high-speed flow downward to the floor, which will form an invisible “wall”. It typically is installed at the door or above the window. When the door or the window is opened, it can effectively separate the inside and outsider air. Thus, it can as much as possible reduce the loss of the cool air and prevent the dust and insect coming in.

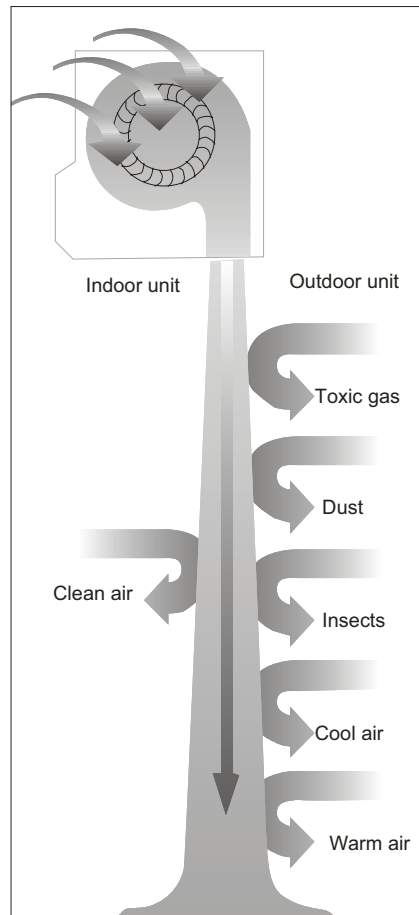



CONTROL

CONTROL

1 Wireless Remote Controller



After energization, press the ON/OFF button of the control panel, the unit will run at high-speed. When pressing the LOW button of the control panel, the unit will be switched over from the high-speed running to the low-speed running. Press ON/OFF button again to turn off the unit.

2 Wired Remote Controller



When pressing the ON/OFF button of the wireless remote control, the unit will run at high-speed. When pressing the FAN SPEED button of control panel, the unit will be switched over from the high-speed running to the low-speed running. Press ON/OFF button again to turn off the unit.



INSTALLATION

INSTALLATION

1 Dimensions Data

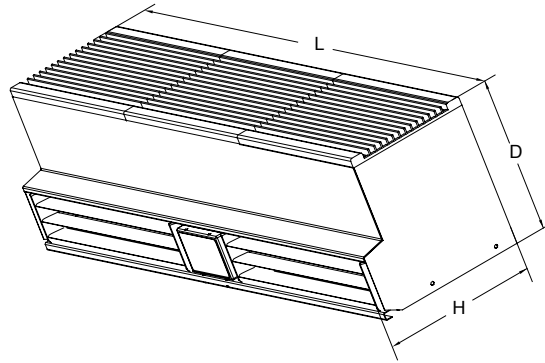

Unit:mm

| MODEL | L | D | H |
|--------------|------|-----|-----|
| FM-1.25-9-K | 900 | 206 | 215 |
| FK-1.25-12-K | 1200 | 206 | 215 |

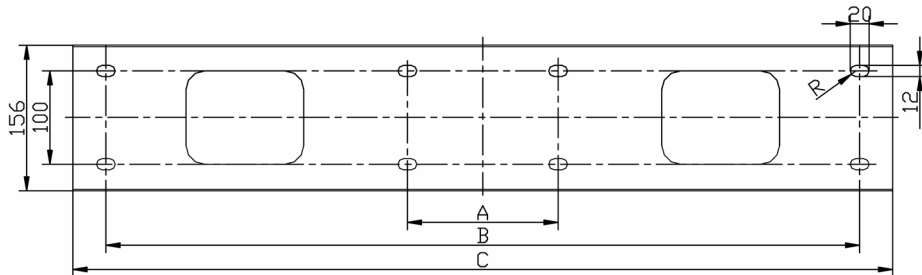

Unit:mm

| MODEL | A | B | C |
|--------------|-----|------|------|
| FM-1.25-9-K | 160 | 800 | 870 |
| FK-1.25-12-K | 160 | 1100 | 1170 |

2 Clearance Data

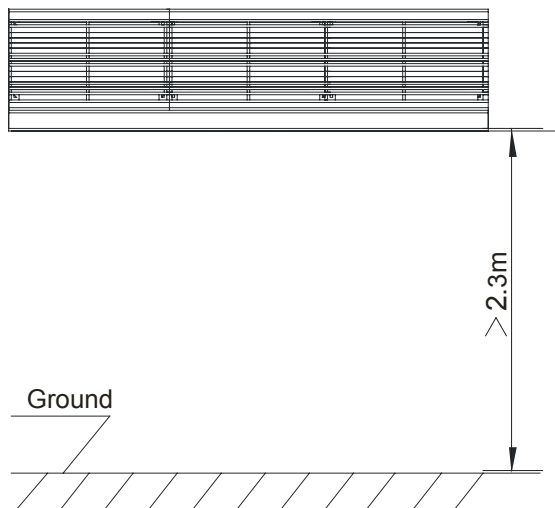



3 Installation Notes

- (1) Please install it in the indoor side.
- (2) Do not install or use the unit under the following place:
- (3) The place where it is frozen.
- (4) The place where steam is produced.
- (5) The place where dust is produced.
- (6) The place where oil and smoke are produced.
- (7) The place where explosive dust or gas exists.
- (8) The place where corrosive gas is produced.
- (9) The place where water can be sprayed to it.
- (10) The place where it is less than 2.3m above the ground.

4 Installation Steps

- (1) Put the installing panel on the expected position and mark out the positions of the holes for the retaining bolts.
- (2) Take out the installing panel and drill the holes on it.
- (3) Hang the unit on the installing panel and tighten the unit through these four bolts.
- (4) Clean the unit; switch on the power supply and then check its running condition.

MAINTENANCE



MAINTENANCE

1 Error Display

| Serial No. | Fault | Cause | Solution |
|------------|------------------|---|----------------------------------|
| 1 | Start-up Failure | The power is not connected properly. | Reconnect the power line |
| | | The fuse on the PCB is broken. | Replace the fuse |
| | | The motor is burnt. | Replace the motor |
| 2 | Abnormal Noise | The bearing of the motor or the fan is damaged. | Replace the motor or the bearing |
| | | The impeller collides with the flow path. | Replace the impeller |

2 Care And Maintenance

When cleaning the unit, be sure to pull the plug out of the unit. Please wipe the body by using soft cloth; use the suction cleaner or vacuum cleaner to clean the unit inside. Lubricate the bearing of the fan motor once a year at least.

3 Wiring Diagram

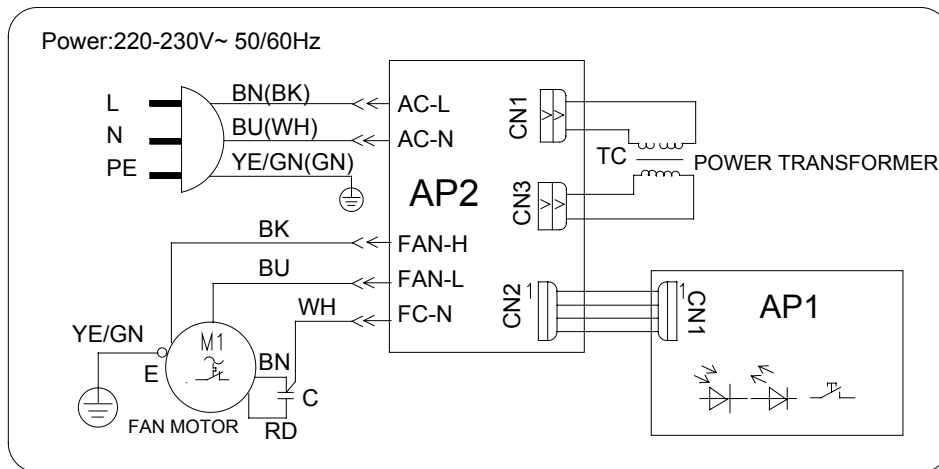

4 Disassembly And Assembly Procedure Of Main Parts

(1) Remove air-in grille. Twist off the screws on air-in grille and then remove the air-in grille.

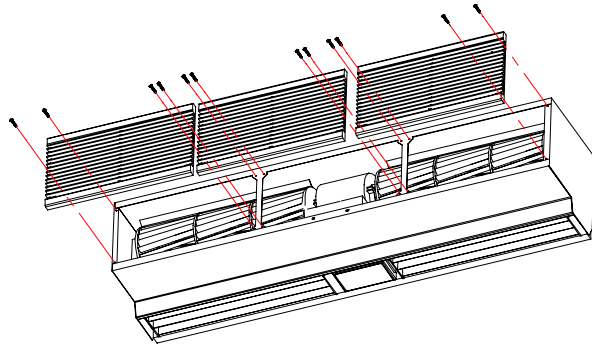

(2) Remove transformer. Twist off the 2 screws in the fig. and then remove the transformer.

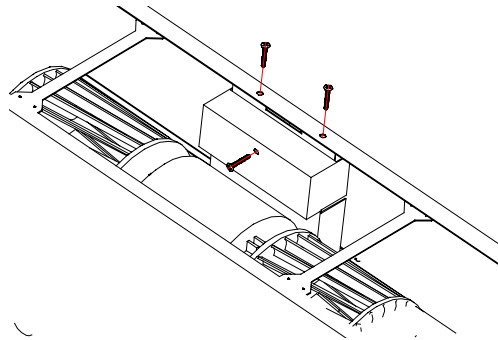

(3) Remove the outer case

Twist off the 7 screws on the outer case and 2 screws around the controller and 2 screws at both side as shown in the fig, and then remove the outer case.

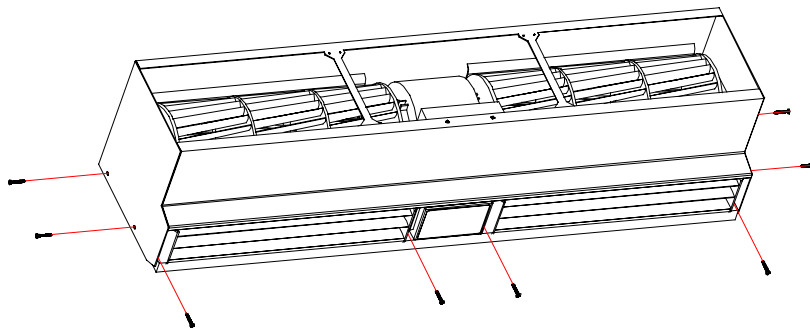

(4) Remove controller

1) Twist off the 4 screws and then remove the weak power control board of controller.

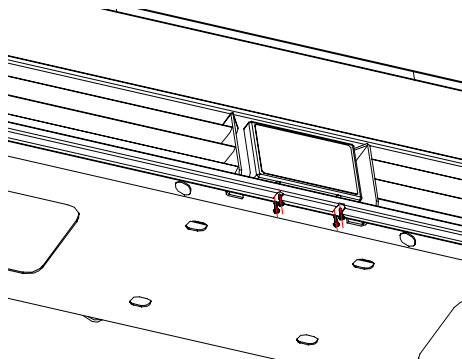



2) Twist off the 4 screws as shown in the fig and then remove the weak power control board of controller.

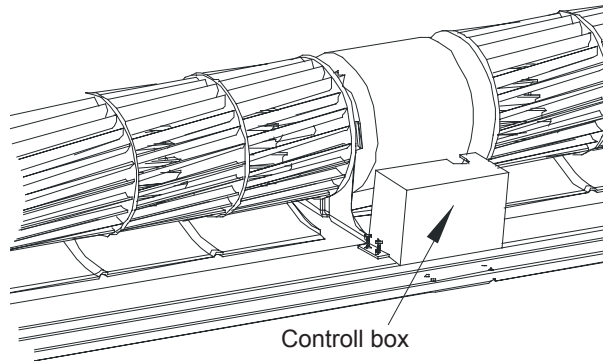

(5) Remove motor
Twist off the 4 nuts at the base of motor with wrench, and then remove the motor.

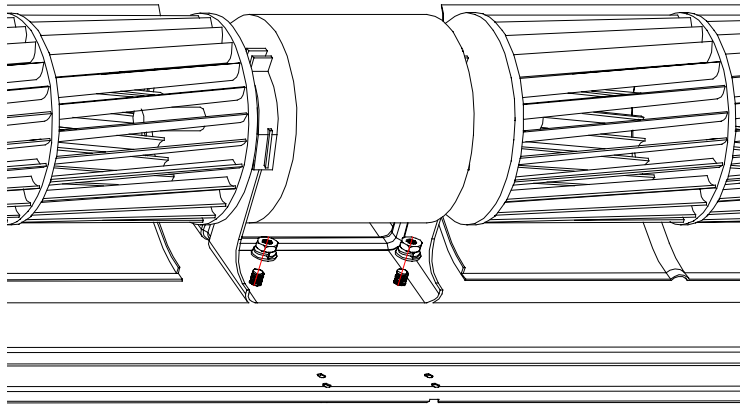

(6) Remove fan blade
Twist off the 3 bolts at both sides of bearing support, and then remove the fan blade.

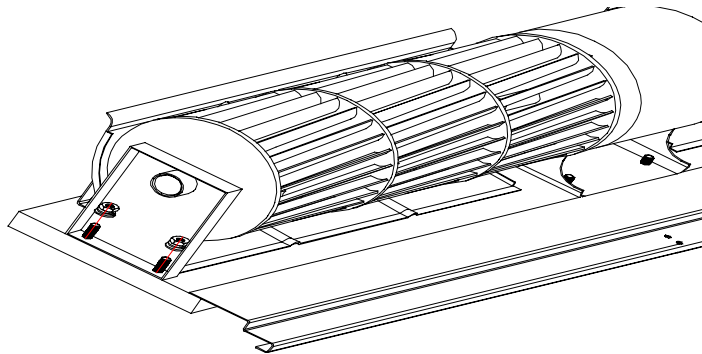

Installation sequence is opposite to above procedure.

5 Exploded View And Spare Part List

5.1 Exploded View

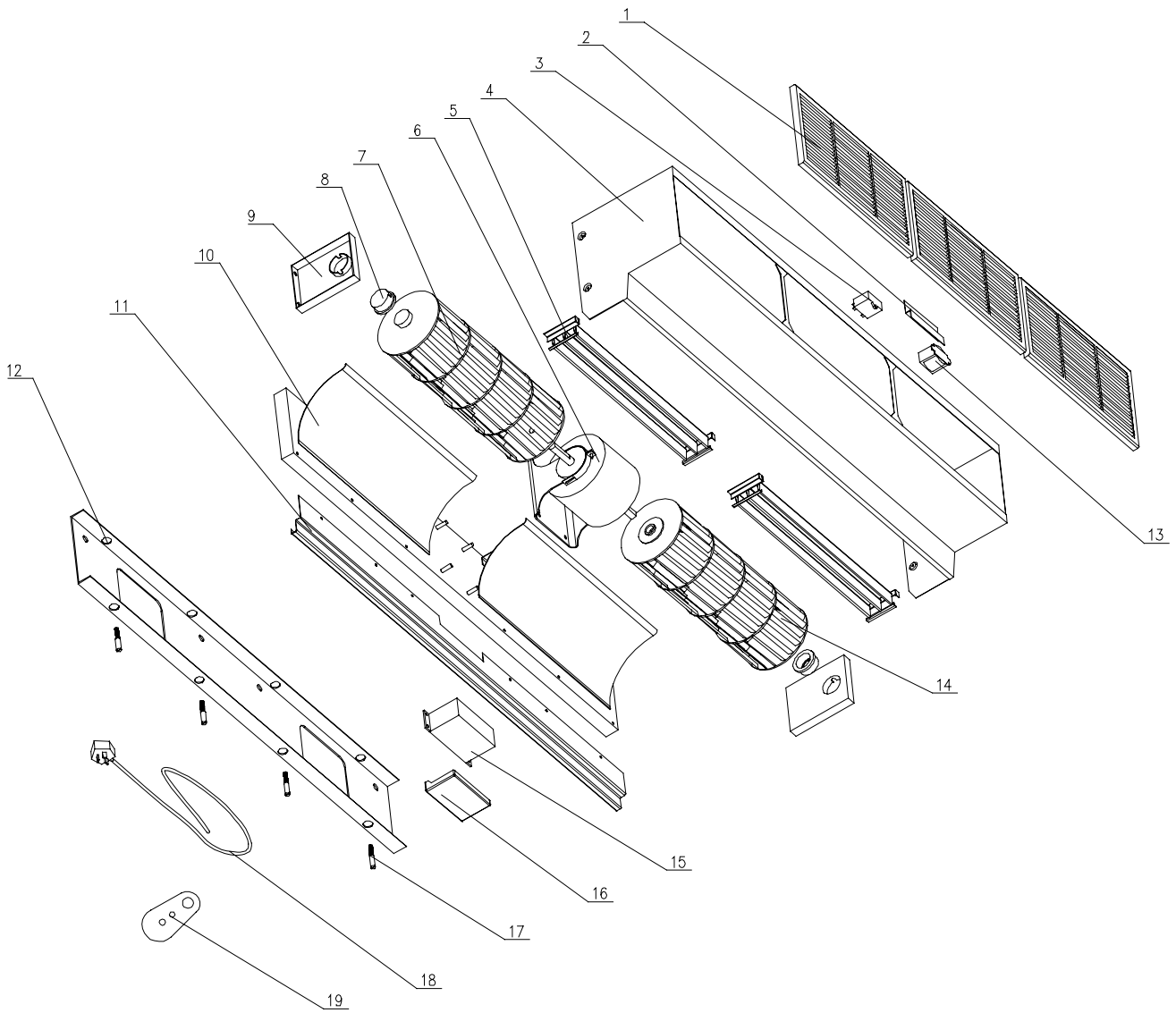

5.2 Parts List

FM-1.25-9-K(CM5500040) Parts List

| No. | Part Name | Material Code | Qty |
|-----|-------------------------|---------------|-----|
| 1 | Plastic Fence | 22419811 | 3 |
| 2 | Transformer Fixer | 01339817 | 1 |
| 3 | Capacitor 3uF/450V | 33010027 | 1 |
| 4 | Case Assay | 01519811 | 1 |
| 5 | Guide Louver Assay | 01379811 | 2 |
| 6 | Motor FM65A | 15019811 | 1 |
| 7 | Left Cross Flow Fan | 10519811 | 1 |
| 8 | Bearing Bush | 76719811 | 2 |
| 9 | Bearing Holder | 01729813 | 2 |
| 10 | Base Assay | 01229810 | 1 |
| 11 | Extended Base | 01799812 | 1 |
| 12 | Wall Mounting Frame | 01339811 | 1 |
| 13 | Transformer SC16B1 | 43110195 | 1 |
| 14 | Right Cross Flow Fan | 10519812 | 1 |
| 15 | Main PCB-2 Z50151 | 30225004 | 1 |
| 16 | Main PCB-1 Z50151 | 30225003 | 1 |
| 17 | Mounting Screw | 70119811 | 4 |
| 18 | Power Cord | 400202681 | 1 |
| 19 | Remote Controller ZY611 | 30506001 | 1 |

FM-1.25-12-K(CM5500050) Parts List

| No. | Part Name | Material Code | Qty |
|-----|-------------------------|---------------|-----|
| 1 | Plastic Fence | 22419811 | 4 |
| 2 | Transformer Fixer | 01339817 | 1 |
| 3 | Capacitor 4uF/450V | 33010011 | 1 |
| 4 | Case Assay | 01519811 | 1 |
| 5 | Guide Louver Assay | 01379811 | 2 |
| 6 | Motor FM65A | 15019811 | 1 |
| 7 | Left Cross Flow Fan | 10519811 | 1 |
| 8 | Bearing Bush | 76719811 | 2 |
| 9 | Bearing Holder | 01729813 | 2 |
| 10 | Base Assay | 01229810 | 1 |
| 11 | Extended Base | 01799812 | 1 |
| 12 | Wall Mounting Frame | 01339811 | 1 |
| 13 | Transformer SC16B1 | 43110195 | 1 |
| 14 | Right Cross Flow Fan | 10519812 | 1 |
| 15 | Main PCB-2 Z50151 | 30225004 | 1 |
| 16 | Main PCB-1 Z50151 | 30225003 | 1 |
| 17 | Mounting Screw | 70119811 | 4 |
| 18 | Power Cord | 400202681 | 1 |
| 19 | Remote Controller ZY611 | 30506001 | 1 |



JF00300404

GREE ELECTRIC APPLIANCES, INC. OF ZHUHAI

Add: West Jinji Rd, Qianshan, Zhuhai, Guangdong, China, 519070

Tel: (+86-756) 8522218 Fax: (+86-756) 8669426

E-mail: gree@gree.com.cn www.gree.com

For continuous improvement in the products, Gree reserves the right to modify the product specification and appearance in this manual without notice and without incurring any obligations.